

MINUTEMAN

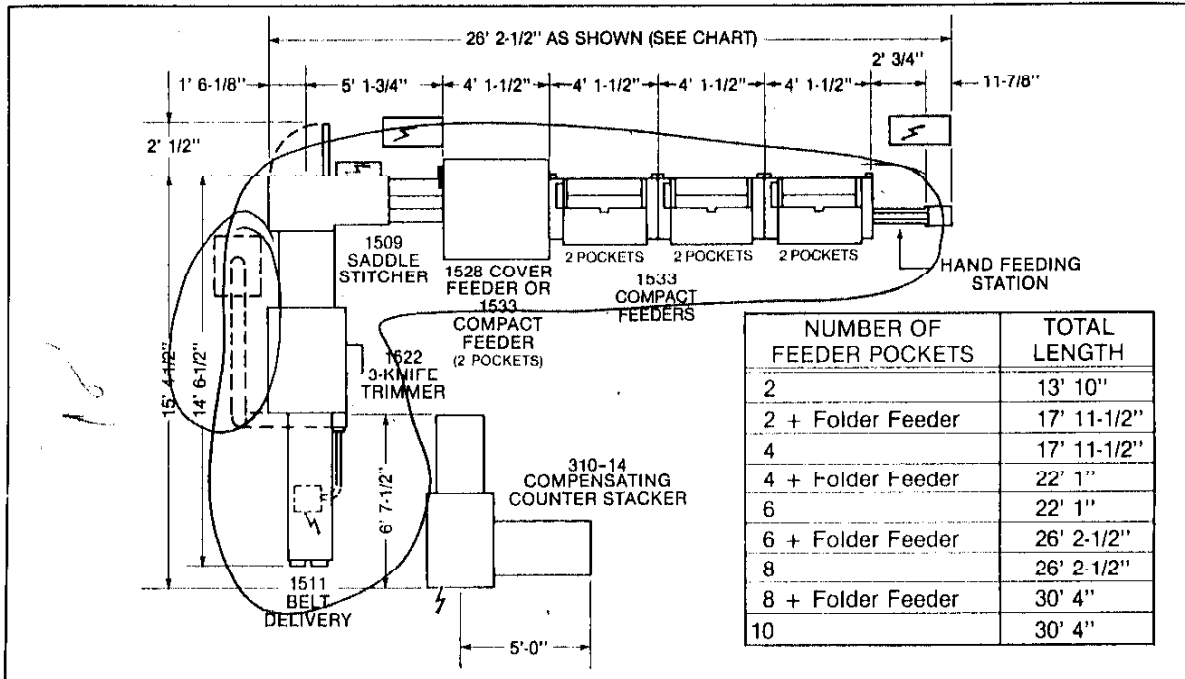

Specifications

1509 "MINUTEMAN" Saddle Stitcher • Feeder 1533 • Trimmer 1522 • Belt Delivery 1511

Sizes

	Width		Backbone Length	
	Untrimmed	Trimmed	Untrimmed	Trimmed
Maximum	9-1/2"	9-3/8"	14-3/8"	13-3/4"
Maximum (oblong)	12"	12"	9-1/4"	9"
Minimum, standard	4-1/8"	3-1/2"	5-3/4"	5-1/2"
Minimum, optional	4"	3"	5-3/4"	3-7/8"
Postcard kit for feeder, Minimum	4"	—	3-1/8"	—

4th & 5th Knife

Maximum	9-1/2"	9-3/8"	14"	6-3/4"
Minimum, standard	4-1/8"	3-1/2"	12"	5-3/4"
Minimum, optional	4"	3"	9-3/4"	4-5/8"

Loading table height	43"
Mechanical speed (maximum)	8,000 c/h
Maximum book thickness	3/8"
Weight, approx. (4 feeder pockets, stitcher, trimmer, compressor, belt delivery)	7,500 lbs.
Electrical requirements (other voltages on request)	230/460V, 60 cps, 3 phase
Power with 4 feeder pockets, (including one compressor)	12.7 HP (9.5kW)
For each additional compressor, add	6.5 HP (4.8kW)

Design, specifications and measurements subject to change

MULLER MARTINI

Muller Martini Corp.

Plant Address:
40 Rabro Drive, Hauppauge, NY 11788
Phone: (516) 582-4343
FAX: (516) 348-1961

Mailing Address:
P.O. Box 3360
Smithtown, NY 11787-0811
Parts FAX: 1-800-258-6855

Minuteman Specs

1.2 SPECIFICATIONS

- A. FLOOR PLAN -- Outline dimensions and a floor plan are shown in figure 1-2.
- B. BOOK SIZES -- Maximum and minimum book sizes correspond to the thickness of the book and to the length and width of the book before and after it is trimmed. For specific dimensions refer to the charts beginning on page 104.
- C. MECHANICAL SPEED RANGE
- | | | | |
|------------|-----------|-------------|-------|
| With 50 Hz | | 2825 - 8000 | C/Hr. |
| With 60 Hz | | 3160 - 8000 | C/Hr. |
- D. AIR REQUIREMENTS
- For Paper Trim Blow Down . . Approx. 25 NM³/Hr. 15 CFM
- E. POWER CONSUMPTION
- | | |
|--------------------------------------|--------|
| Main Motor | 3.7 kW |
| Delivery Motor | 0.4 kW |
| Misc. Electrical Equipment | 0.2 kW |
- F. WEIGHT
- Trimmer Approx. 1225 kg 2700 lbs.

NORMALFORMAT
 STANDARD SIZE
 FORMATO NORMAL
 FORMAT NORMAL

FIG 1-3		A	A1	B	B1	C	D	E
MAX	MM	360	365	300	305	50	10	35
	IN.	14 1/4	14 3/8	11 13/16	12	2	3/8	1 3/8
MIN	MM	140	-	90	-	3	-	3
	IN.	5 1/2	-	3 1/2	-	1/8	-	1/8

KLEINFORMAT
 SMALL SIZE
 FORMATO PEQUENO
 PETIT FORMAT

part # 1522.0150 437.85 1-3

FIG 1-3		A	B	C
MIN	MM	98	76	3
	IN.	3 7/8	3	1/8

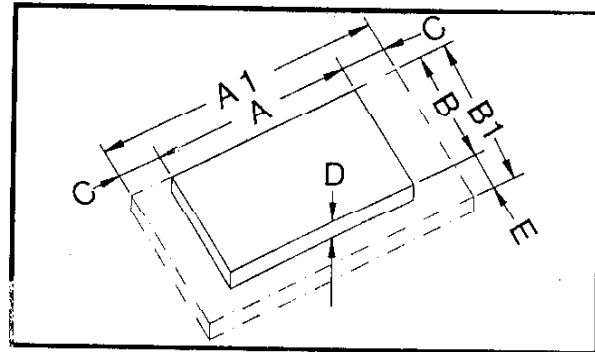

TRENNSCHNITT NORMALFORMAT
 SPLIT CUT STANDARD SIZE
 CORTE SEPERADOR FORMATO NORMAL
 REFENTE SIMPLE, FORMAT NORMAL

FIG 1-4		A	A1	B	B1	C	D	E
MAX	MM	180	365	275	305	50	6	35
	IN.	7 1/16	14 3/8	10 3/4	12	2	1/4	1 3/8
MIN	MM	145	296	90	93	3	-	3
	IN.	5 3/4	11 5/8	3 1/2	3 5/8	1/8	-	1/8

TRENNSCHNITT KLEINFORMAT
 SPLIT CUT SMALL SIZE
 CORTE SEPERADOR FORMATO PEQUENO
 REFENTE SIMPLE, PETIT FORMAT

FIG 1-4		A	A1	B
MIN	MM	118	210	90
	IN.	4 5/8	8 1/4	3 1/2

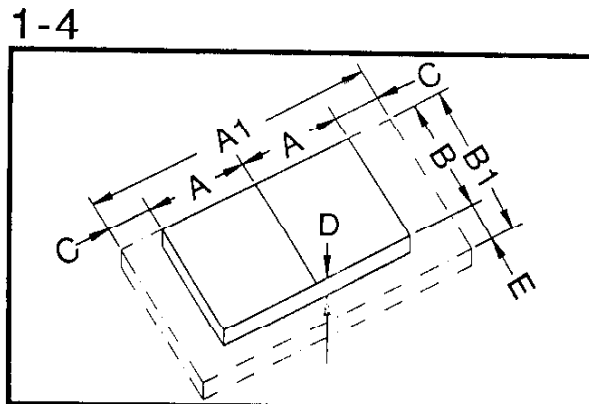

03.93

STANNSCHNITTNORMALFORMAT
 PUNCH CUT STANDARD SIZE
 CORTE TROQUELADO FORMATO NORMAL
 REFENTE DOUBLE, FORMAT NORMAL

FIG 1-5		A	A1	B	B1	C	D	E	F
MAX	MM	177	365	275	305	50	6	10	35
	IN.	7	14 ³ / ₈	10 ³ / ₄	12	2	¹ / ₄	³ / ₈	1 ³ / ₈
MIN	MM	140	296	90	93	3	-	4	3
	IN.	5 ¹ / ₂	11 ⁵ / ₈	3 ¹ / ₂	3 ⁵ / ₈	¹ / ₈	-	³ / ₁₆	¹ / ₈

STANNSCHNITT KLEINFORMAT
 PUNCH CUT SMALL SIZE
 CORTE TROQUELADO FORMATO PEQUENO
 REFENTE DOUBLE, PETIT FORMAT

FIG 1-5		A	A1	B
MIN	MM	115	216	90
	IN.	4 ¹ / ₂	8 ¹ / ₂	3 ¹ / ₂

1-5

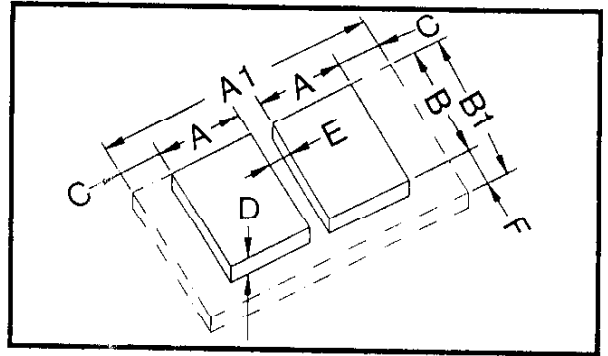

LOCHSTANZUNG FUER EIN LOCH
 SINGLE HOLE PUNCH
 PUNXONADO PARA UN AGUJERO
 PERFORATION A UN TROU

FIG 1-6		A	A1	B	B1	C	D	E	F	G
MAX	MM	360	365	300	305	50	5	5	9.5	35
	IN.	14 ¹ / ₄	14 ³ / ₈	11 ¹³ / ₁₆	12	2	³ / ₁₆	2	³ / ₈	1 ³ / ₈
MIN	MM	215	-	105	-	3	-	-	4.8	3
	IN.	8 ¹ / ₂	-	4 ⁴ / ₈	-	¹ / ₈	-	-	³ / ₁₆	¹ / ₈

1-6

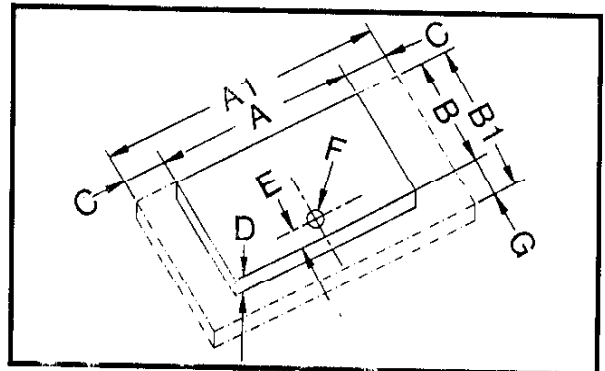

03.93